

364

GEW. TERRAIN:  
-2.35 (469.42)  
NEUES TERRAIN:  
-2.55 (469.22)

GEW. TERRAIN:  
-1.05 (470.72)  
NEUES TERRAIN:  
-1.45 (470.32)

GEW. TERRAIN:  
-1.87 (469.90)  
NEUES TERRAIN:  
+0.05 (471.82)

GEW. TERRAIN:  
-0.55 (471.22)  
NEUES TERRAIN:  
+0.05 (471.82)

# 5 1/2-Zimmer-Wohnung Erdgeschoss Haus West

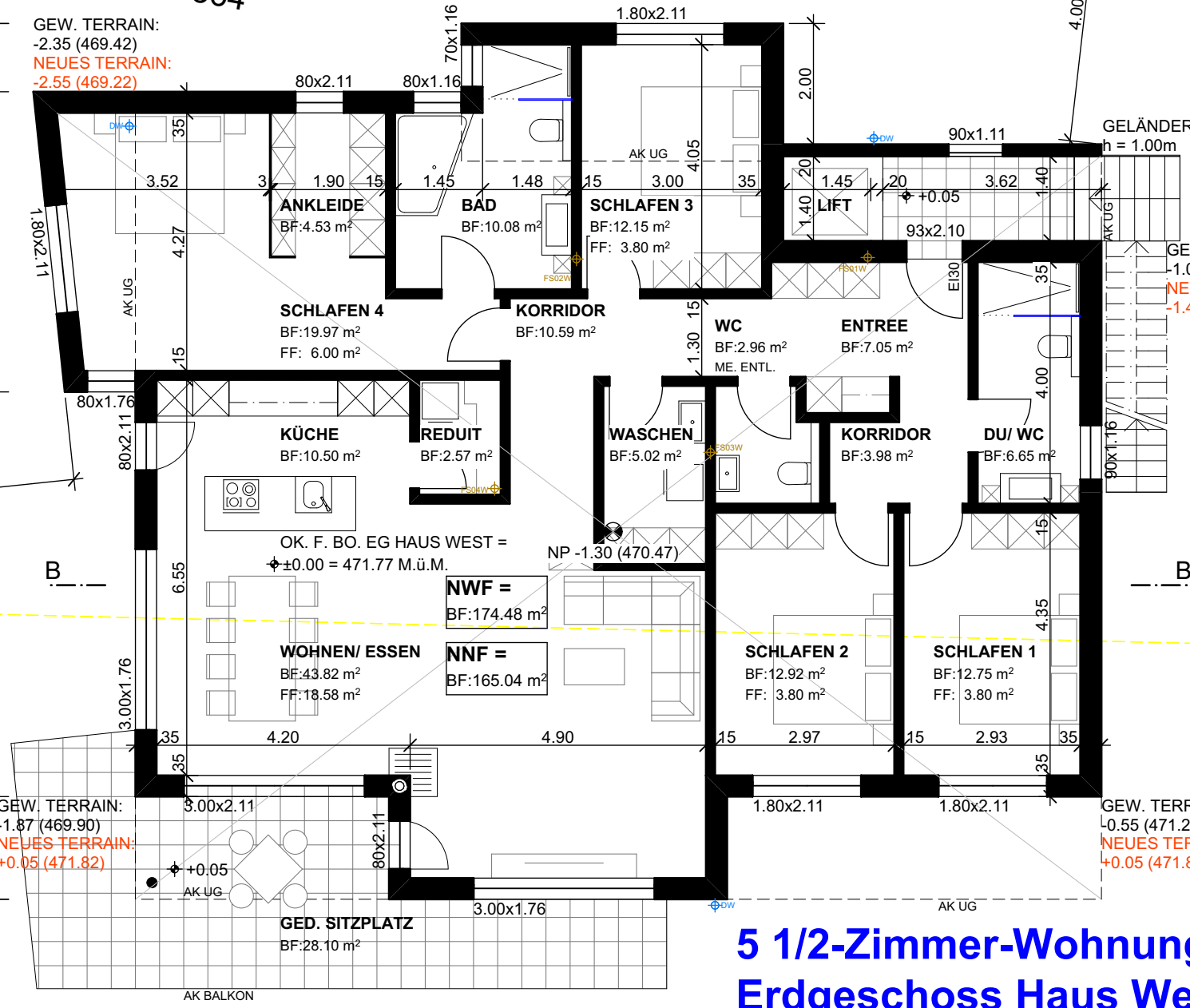

OK. F. BO. EG HAUS WEST =  
±0.00 = 471.77 M.ü.M.

NWF =  
BF:174.48 m²

NNF =  
BF:165.04 m²

AK BALKON

GELÄNDER h = 1.00m  
AK UG

